

INSTRUCTION MANUAL

- 1. Always ensure the power is completely OFF before any installation or maintenance.**
- 2. The fixture must be installed by a qualified licensed electrician**

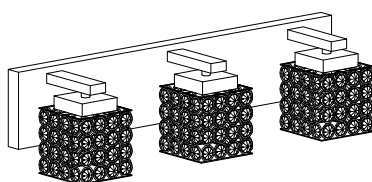

V1910-3

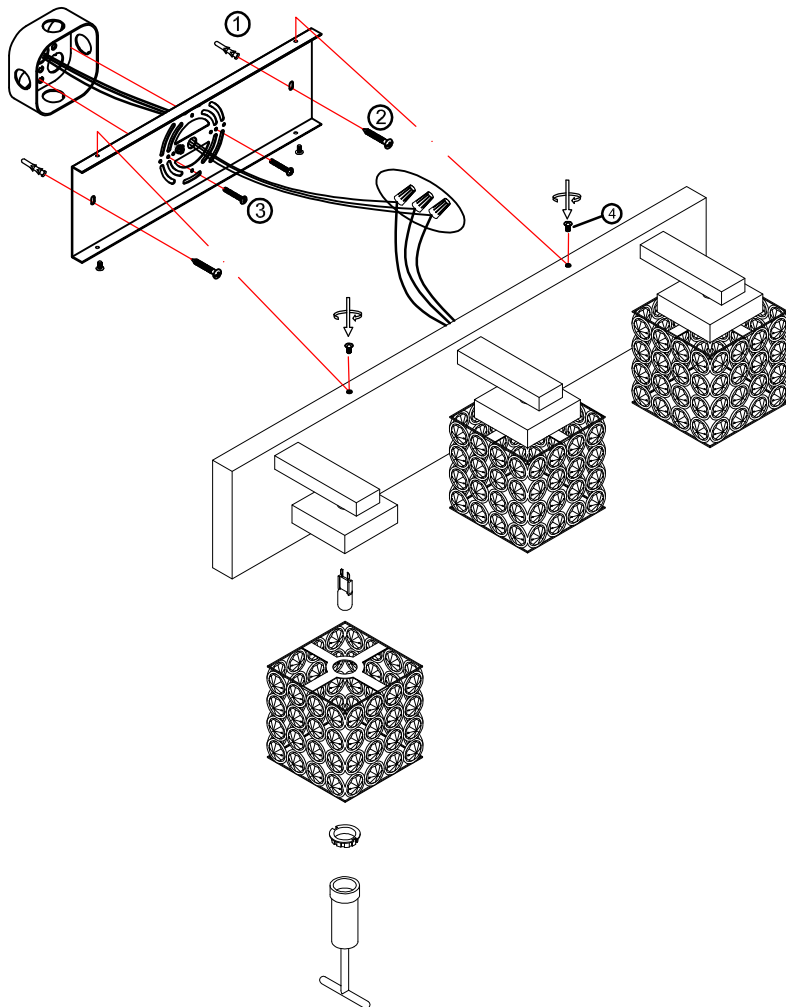
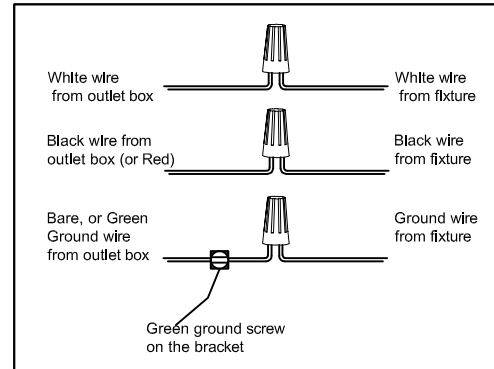

- 1. Ensure main supply is switched off.**
- 2. Put the anchoring (1) into the hole on the wall, have the screw (2) through the mounting bracket, and tighten with anchoring.**
- 3. Have the mounting screw (3) through the mounting bracket and screw into octagon box.**
- 4. Install the light bulb (not provided) to the socket, put the crystal shade to the socket cup. Use socket ring tool to secure the shade.**
- 5. Connect the wires using wire nuts, tight mounting bracket and back plate using screws (5).**

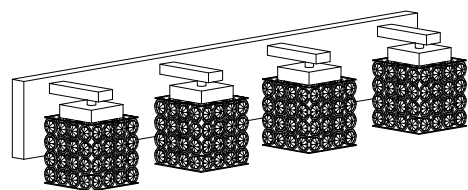

V1910-4