

# INSTRUCTION MANUAL

1. **ALways enure the power is completely OFF before any installation or maintenance.**
2. **The fixture must be installed by a qualified licensed electrician**

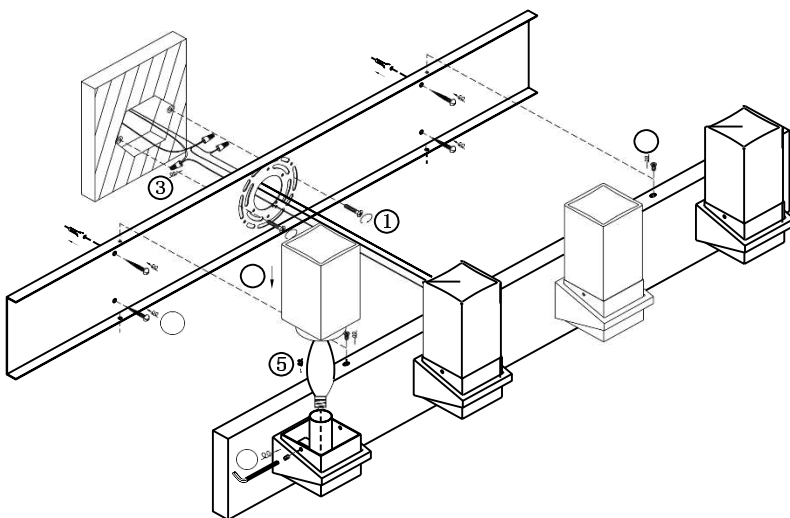
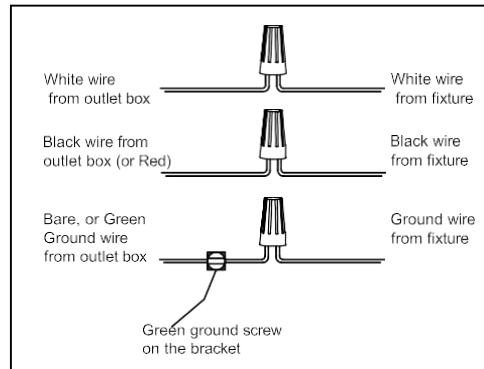

1. Ensure main supply is switched off.
2. Have the mounting screw (1) through the mounting bracket and screw into octagon box.
3. Connect the wires using the wire nuts, tight mounting bracket and back plate using screws.
4. Place the glass in place and tight it with the Allen screws (L-Shaped tool)
5. Install the bulbs (not included) into socket.

VL9323-3CH  
VL9323-3BK  
VL9323-3AB  
VL9323-3AB/BK

VL9323-4CH  
VL9323-4BK  
VL9323-4AB  
VL9323-4AB/BK

WS9323-1CH  
WS9323-1BK  
WS9323-1AB  
WS9323-1AB/BK